

Smt. Sumita Roy

B.Sc,Dip In Arch
L.B.S[CI-I] - HMC
L.B.S[CI-I] - HZP

Resi :

Jhorehat Rajar Bagan
Jhorehat, Andul
Howrah-711302

Ref.....

Date:14.10.2023

TO WHOM IT MAY CONCERN

I do here by declare that the erection of the building of W.B. Estate Developer Pvt. Ltd. sanction vide Memo No. - 146/032/HZP/PS, dated : - 14.08.2023 on L.R. Dag No. – 5585,5589,5593 L.R. Khatian No.- 69464, J.L. No. – 14, Mouza – Bally, P.S. – Bally (Old), Nischinda(New), Dist. – Howrah. Latitude – 22.649955° N, Longitude – 88.337765° E will be commenced on 02.01.2024 under my supervision.

Smt. Sumita Roy [Guhar]
B.Sc. Dip In Arch
L.B.S. [Class-I] No. 16 of
Howrah Zilla Parisad
Jhorehat, Andul, Howrah

CONTACT : 9433706697
e-mail at : sumitaroy13@yahoo.in

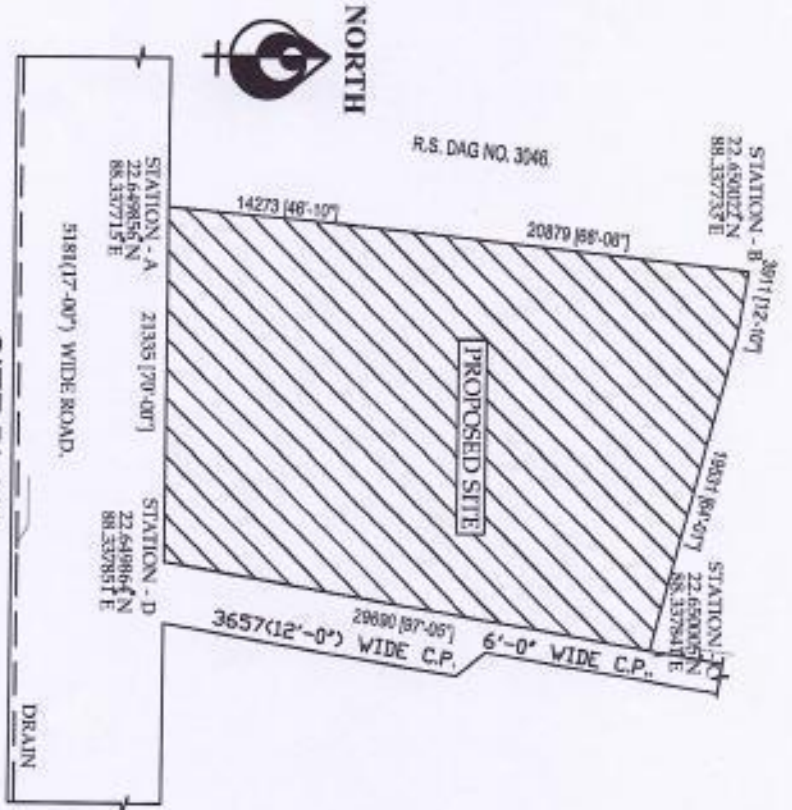

SITE PLAN

SCALE-1:400



LOCATION MAP

SCALE-N/T'S

SITE PLAN OF L.R. DAG NO. -
5585,5589,5593, KHATIAN NO.:-69464,
J.L. NO. - 14, MOUZA-BALLY,
P.S. - BALLY, DIST.-HOWRAH.

LAND AREA (AS PER DEED) =
18 SATAK = 729,086 SQ.MT.
LAND AREA (AS MEASUREMENT) =
15.64 SATAK = 674,009 SQ.MT.

SITE PLAN WITH CO-ORDINATE

LAND AREA :

Smt. Sumita Roy
Smt. Sumita Roy [Chhat]
B.Sc. Dip In Arch
L.B.S. [Class-I] No. 16 of
Howrah Zilla Parishad
Jhorehat, Andul, Howrah

W. B. Estate Developers Pvt. Ltd.
Achintya Kumar Mondal
Director

SIGNATURE OF L.B.S.

SIGNATURE OF OWNER